

829+804

mm.91,8x17,7

Cod. C1829804 **NIKOO**
 Cod. C1829804 **OTTOO**
 Cod. C1829804 **BROOO**

Cerniere invisibili regolabili per porte
 Invisible adjustable hinges for doors
 Bisagras invisibles ajustables para puertas



CARATTERISTICHE:

- Realizzata in zama in 3 diverse finiture
- Adatta per ante con spessore minimo di 24 mm
- Lunghezza totale solo 92 mm
- Profondità solo 25 mm
- Regolazione bidimensionale (verticale e profondità)
- Portata fino a 25 kg
- Easy installation e simmetria di cava

MAIN FEATURES:

- Produced in zamak in 3 different finishes
- Suitable for doors of 24 mm min. thickness
- Total length 92 mm
- Depth 25 mm
- 2D (vertical and depth) adjusting system
- Load capacity up to 25 kg
- Easy installation and slot symmetry

CARACTERÍSTICAS:

- Fabricada en zamak en 3 acabados diferentes
- Adapta para puertas con un espesor mínimo de 24 mm
- Longitud total 92 mm
- Profundidad de 25 mm
- Ajuste en 2D (vertical y profundidad)
- Capacidad de carga hasta 25 kg
- Easy installation y simetría de corte

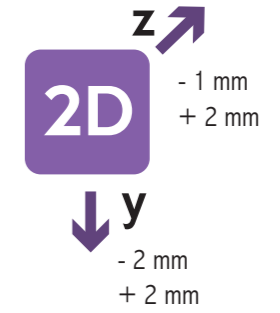
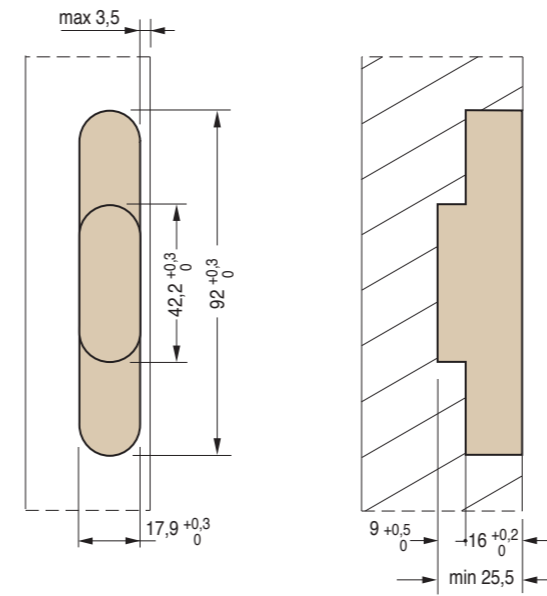

REVERSIBILITÀ - REVERSIBILITY - REVERSIBILIDAD

Reversibile per porte da 24 mm a 25 mm di spessore
 Reversible for doors from 24 mm to 25 mm thick
 Reversible para puertas de 24 mm hasta 25 mm de espesor

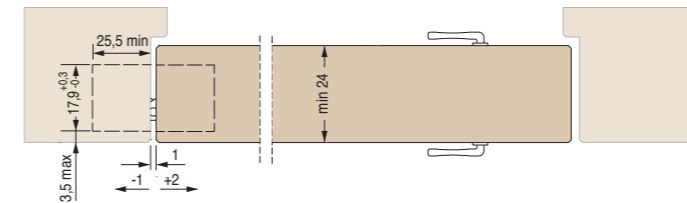
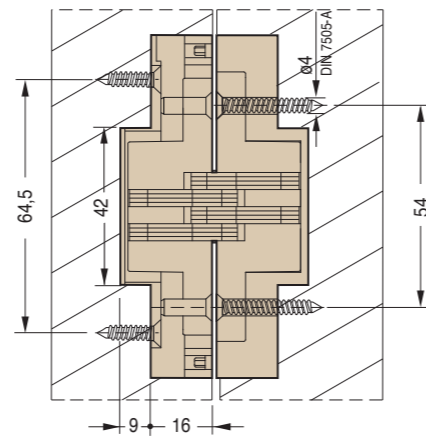
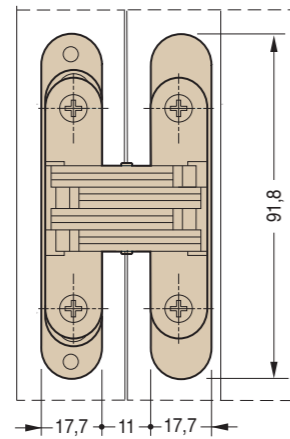
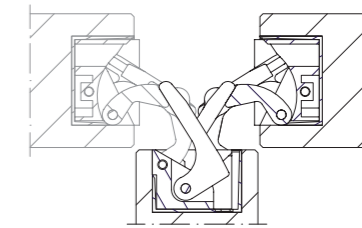

Sezione porta
 Door cross-section
 Sección de puerta

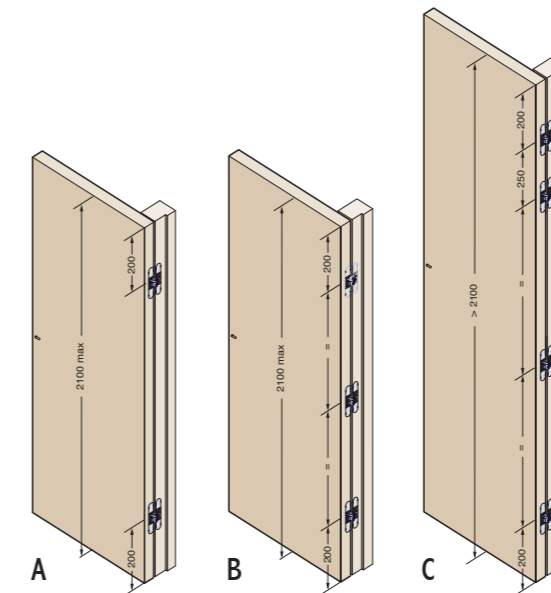
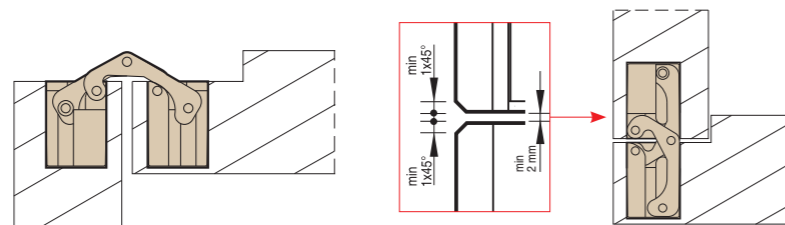

PORTATA ANTE

Larghe fino a 850 mm
 Alte fino a 2100 mm
 A - 2 cerniere kg 15
 B - 3 cerniere kg 25
 Alte oltre 2100 mm
 C - 4 cerniere kg 25

CAPACITY DOORS

Width up to 850 mm
 Alte fino a 2100 mm
 A - 2 hinges kg 15
 B - 3 hinges kg 25
 More than 2100 mm high
 C - 4 hinges kg 25

CAPACIDAD PUERTAS

Anchas hasta 850 mm
 Altas hasta 2100 mm
 A - 2 bisagras kg 15
 B - 3 bisagras kg 25
 Mas altas que 2100 mm
 C - 4 bisagras kg 25



Basetta regolabile
Adjustable base
Base ajustable



Montaggio
Mounting
Montaje

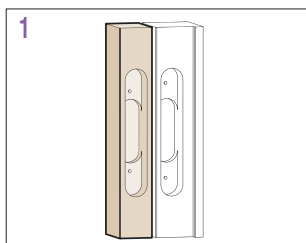

Esecuzione delle cave nella porta e nello stipite.

Implementation of hollow spaces both in the door and in the post.

Ejecución de cortes en el marco y en la hoja de la puerta.

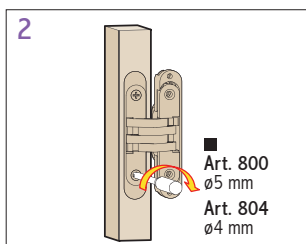

Montaggio della basetta fissa e della cerniera nella porta; vite autofilettante testa svasata piana. ■

Mounting of a fixed base and door hinge; flat countersunk-head self-tapping screw. ■

Montaje de la base fija y de la bisagra en la puerta; tornillo autorroscante de cabeza avellanada. ■

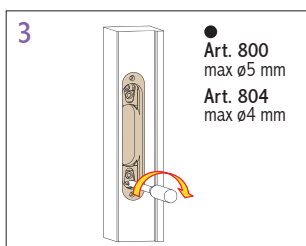

Montaggio della basetta regolabile nello stipite; **Importante:** vite autofilettante testa svasata piana. ●

Mounting of adjustable base on the post; **Attention:** flat countersunk-head self-tapping screw. ●

Montaje de la base ajustable en el marco; **Importante:** tornillo autorroscante de cabeza avellanada. ●

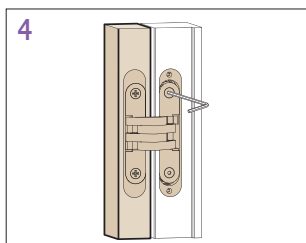

Montaggio cerniera nello stipite; vite testa svasata, brugola inserite nel kit.

Mounting of hinge on the post: countersunk-head screw, Allen screw included in the kit.

Montaje de la bisagra en el marco; tornillos avellanados, llave de montaje incluidos en el kit.

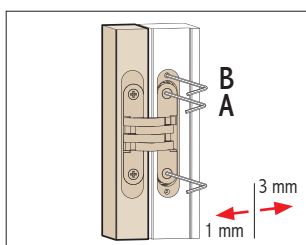

- Allentare A
- Regolare B
- Serrare A
- Loosen A
- Adjust B
- Tighten A
- Aflojar A
- Ajustar B
- Apriar A

Regolazione in profondità
Depth adjustment
Ajuste de profundidad

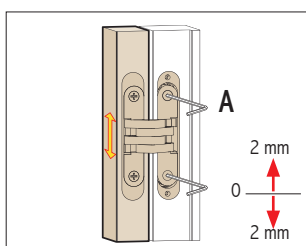

- Allentare A
- Regolare la porta
- Serrare A
- Loosen A
- Adjust the door
- Tighten A
- Aflojar A
- Ajustar la puerta
- Apriar A

Regolazione verticale
Vertical adjustment
Ajuste vertical

